



**PARAMOUNT LAND**  
Building homes and people with heart

A graphic celebrating Merdeka Salebration 2021. The text 'MERDEKA' is in white with a red and white striped banner above it. 'SALEBRATION' is in large, bold, yellow and white letters with a black outline. '2021' is in large, bold, white letters with a black outline. The text is surrounded by colorful, abstract shapes in purple, blue, yellow, and red, resembling a burst or explosion. The background is a red and white striped flag.

**MERDEKA**  
**SALEBRATION**  
**2021**



**PARAMOUNT LAND**  
Building homes and people with heart



**PERIODE 23 JULI – 30 SEPTEMBER 2021**



**PARAMOUNT LAND**  
Building homes and people with heart

**HARGA SPESIAL**

---

**CARA BAYAR  
MENGUNTUNGKAN**

---

**UNIT TERBATAS**

---

**HADIAH MENARIK**



## BUNGA KPR SPESIAL

---



A member of  MUFG, a global financial group



NEW  
ALICANTE



SOLVANG  
GRANDE



Bavaria  
GRANDE





NEW  
**ALICANTE**



TYPE **8** HOEK



TYPE **8** STANDAR



## TYPE 8 HOEK



UKURAN TANAH : 8 X 18    LUAS TANAH : VAR    LUAS BANGUNAN : 179 M<sup>2</sup>



## TYPE 8 STANDAR



UKURAN TANAH : 8 X 18    LUAS TANAH : 144 M<sup>2</sup>    LUAS BANGUNAN : 173 M<sup>2</sup>





# NEW ALICANTE



## FACADE & INTERIOR L8





NEW  
**ALICANTE**



TYPE **7** HOEK



TYPE **7** STANDAR



## TYPE 7 HOEK



UKURAN TANAH : 7 X 18    LUAS TANAH : VAR    LUAS BANGUNAN : 169 M<sup>2</sup>

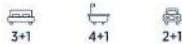

## TYPE 7 STANDAR



UKURAN TANAH : 7 X 18    LUAS TANAH : 126 M<sup>2</sup>    LUAS BANGUNAN : 158 M<sup>2</sup>





# NEW ALICANTE



## FACADE & INTERIOR L7





# NEW ALICANTE



# SITEPLAN & SPESIFIKASI TEKNIS



Available Unit



## SPESIFIKASI FINISHING

- EXTERIOR**
- Facade : Finishing Cat
  - Carport : Lantai keramik 40x40 (non-slip)
- INTERIOR**
- Lantai Utama : Homogeneous Tile 60x60
  - Lantai Kamar Mandi : Keramik 50x50
  - Lantai Ruang Servis : Keramik 40x40
  - Lantai Teras : Keramik 40x40
  - Dinding : Finishing Cat
  - Kusen : Aluminium
  - Daun Pintu : Solid Engineering Wood Finish Duco (pintu utama)
  - Engineering Door (semua pintu dalam dan kamar mandi)
- Hardware/Ironmongery** : Deckson atau setara
- Sanitary : Toto atau setara
  - Plafond : Gypsum Finish Cat
  - Lamp Fitting : Downlight

## SPESIFIKASI TEKNIS

- Pondasi : Straus Pile
- Dinding : Bata Ringan
- Struktur : Beton Bertulang
- Rangka Atap : Baja Ringan
- Penutup Atap : Genteng Keramik
- Listrik : 3500 VA (L7 & L8)
- Air : WTP



# NEW ALICANTE



# PETA LOKASI



**PARAMOUNT LAND**  
Building homes and people with heart



MERDEKA  
**SALEBRATION**  
2021



**ZUMA**  
@Malibu Village



TYPE **7** STANDAR



TYPE **6** STANDAR



**PARAMOUNT LAND**  
Building homes and people with heart

## TYPE 7 STANDAR



UKURAN TANAH : 7 X 8    LUAS TANAH : 56 M<sup>2</sup>    LUAS BANGUNAN : 71 M<sup>2</sup>



## TYPE 6 STANDAR



UKURAN TANAH : 6 X 8    LUAS TANAH : 48 M<sup>2</sup>    LUAS BANGUNAN : 58 M<sup>2</sup>



# ZUMA @ MALIBU VILLAGE



## FACADE & INTERIOR L7

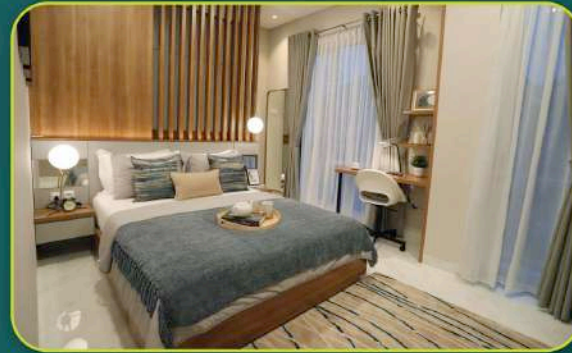



# ZUMA @ MALIBU VILLAGE



## FACADE & INTERIOR L6





# ZUMA @ MALIBU VILLAGE



## SITEPLAN & SPESIFIKASI TEKNIS



Available Unit

Show Unit



### SPESIFIKASI FINISHING

<b>EXTERIOR</b>	
Facade	: Finishing Cat
Carport	: Lantai keramik 40x40 (non-slip)
<b>INTERIOR</b>	
Lantai Utama	: Keramik 40x40
Lantai Kamar Mandi	: Keramik 25x25
Lantai Teras	: Keramik 40x40
Dinding	: Finishing Cat
Kusen	: Aluminium Anodize
Daun Pintu	: Solid Engineering Door (pintu utama) Engineering Door (semua pintu dalam dan kamar mandi)
Hardware/Ironmongery	: Hampton
Sanitary	: Toto atau setara
Plafond	: Gypsum Finish Cat
Lamp Fitting	: Downlight

### SPESIFIKASI TEKNIS

Pondasi	: Tapak Beton & Batu Kali
Dinding	: Bata Ringan
Struktur	: Beton Bertulang
Rangka Atap	: Baja Ringan
Penutup Atap	: Genteng Beton
Listrik	: 2200 VA
Air	: WTP



# ZUMA @ MALIBU VILLAGE



## PETA LOKASI





MERDEKA  
SALEBRATION  
2021

# SOLVANG

## GRANDE



**PARAMOUNT LAND**  
Building homes and people with heart



Type **4,5x9** LT: **40,5 m<sup>2</sup>** | LB: **81 m<sup>2</sup>**

Type **4,5x10** LT: **45 m<sup>2</sup>** | LB: **90 m<sup>2</sup>**

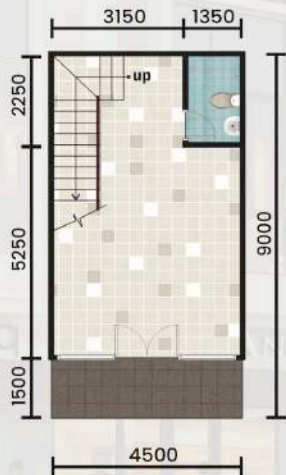

**DENAH LANTAI 1**

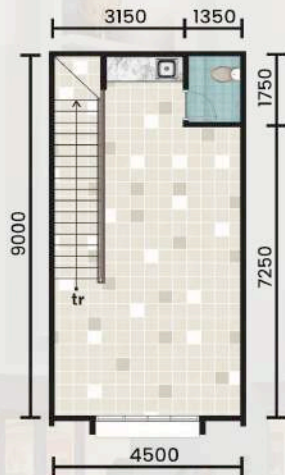

**DENAH LANTAI 2**

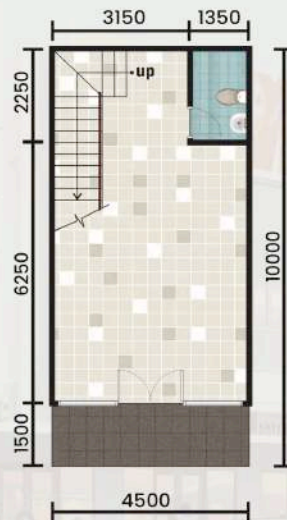

**DENAH LANTAI 1**

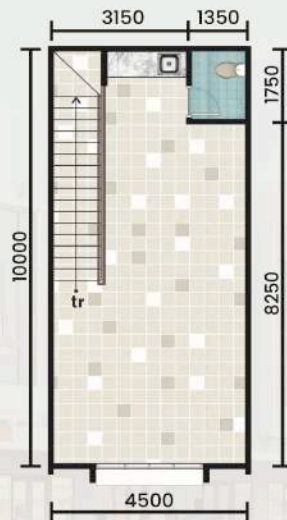

**DENAH LANTAI 2**



Type **4,5x14** LT: **63 m<sup>2</sup>** | LB: **107 m<sup>2</sup>**

Type **5,5x14** (Hoek) LT: **77 m<sup>2</sup>** | LB: **131 m<sup>2</sup>**

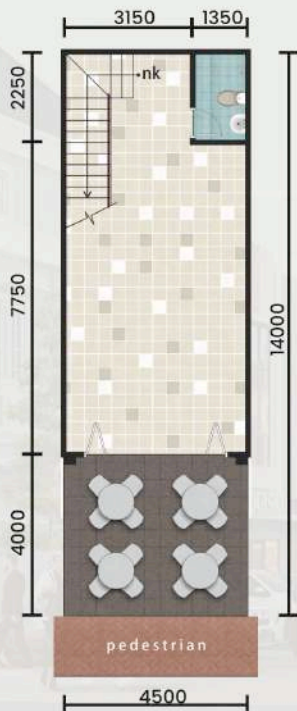

**DENAH LANTAI 1**

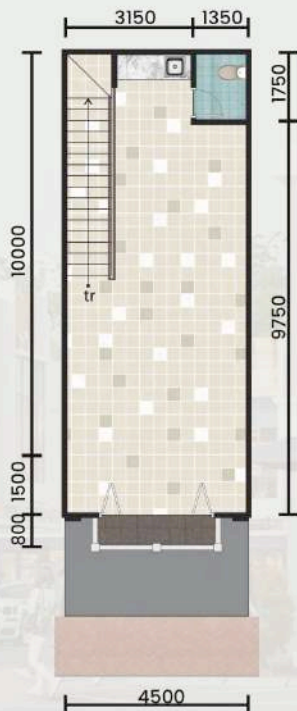

**DENAH LANTAI 2**

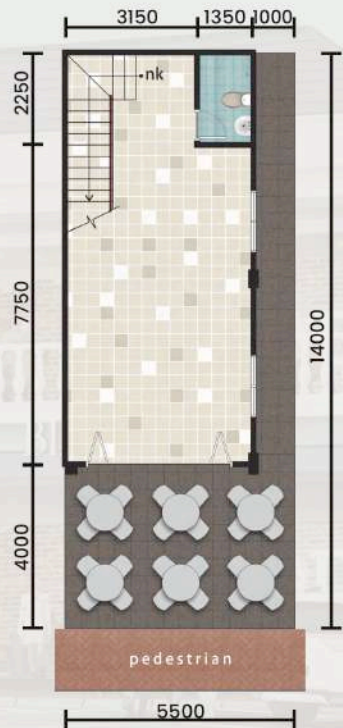

**DENAH LANTAI 1**

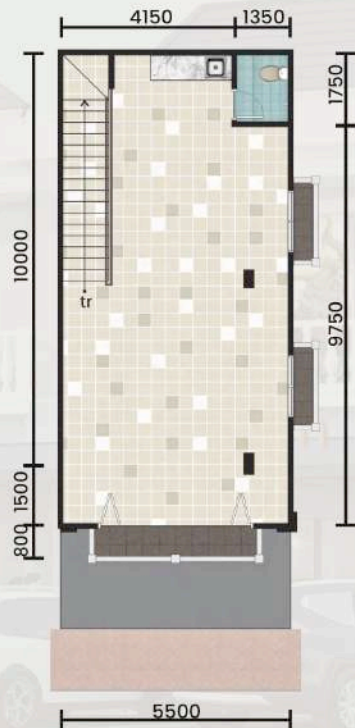

**DENAH LANTAI 2**



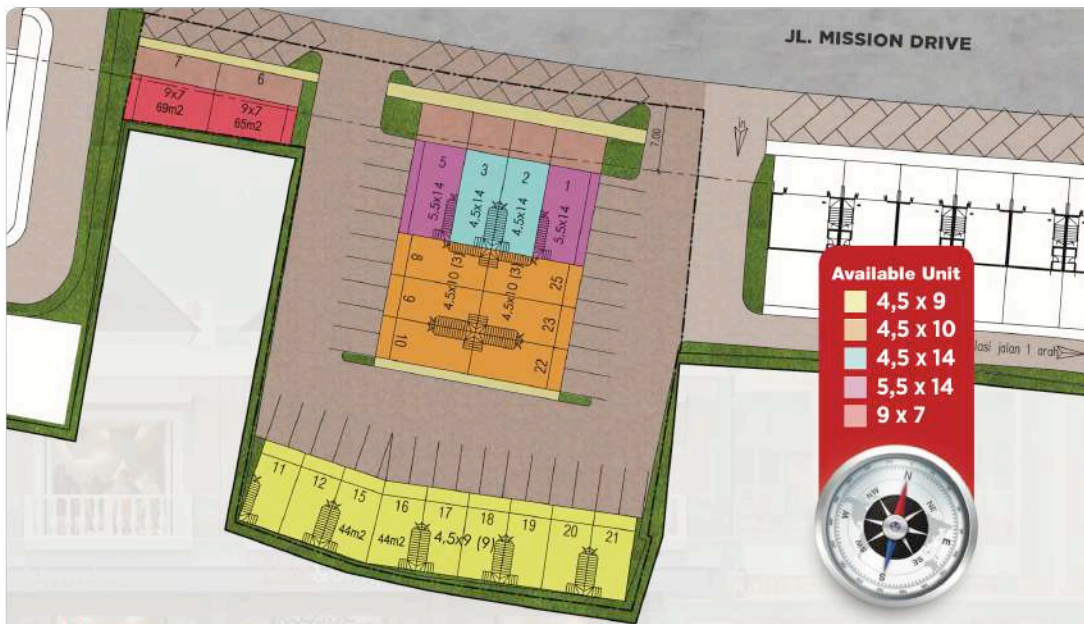

## SPESIFIKASI TEKNIS

**Pondasi** Tiang Pancang (mini pile) • **Struktur Kolom, Balok, Dak, Sloof, Ring Balok, Tangga** Beton Bertulang • **Rangka atap** Rangka Baja Ringan (Zincalum) • **Penutup Atap** Atap metal (Zincalum) + aluminium foil • **Lantai Utama** Homogenous Tile 60x60 • **Lantai Teras** Keramik 40x40 • **Lantai KM/WC** Keramik 30x30 • **Dinding Dalam** Bata Ringan dipleser + aci • **Dinding Luar** Bata Ringan dipleser finish Cat Weather Resistant Acrylic Emulsion Paint • **Dinding KM/WC** Keramik 30x60 • **Plafond Dalam** Gypsumboard • **Plafond Luar** Gypsum Waterproof • **Sanitary** ex. Amstad • **Pintu/Jendela Utama** Kaca Clear Frame Aluminium fin Powder Coating • **Pintu/Jendela Lainnya** Kaca Clear Frame Aluminium fin Powder Coating • **Pintu KM/WC** Panel dan kusen PVC • **Canopy Teras Depan** Outdoor Awning Fabric + Rangka Besi hollow • **INSTALASI** : **Listrik** Suplai PLN Daya 3500 VA • **Telepon** Instalasi Kabel • **Air Bersih** Suplai PDAM + Toren • **Air Kotor** Septictank

## POTONGAN RUKO







**Latigo**  
SQUARE

MERDEKA  
**SALEBRATION**  
2021



**PARAMOUNT LAND**  
Building homes and people with heart

Type **4,5x10** LT : **45 m<sup>2</sup>** | LB : **90 m<sup>2</sup>**

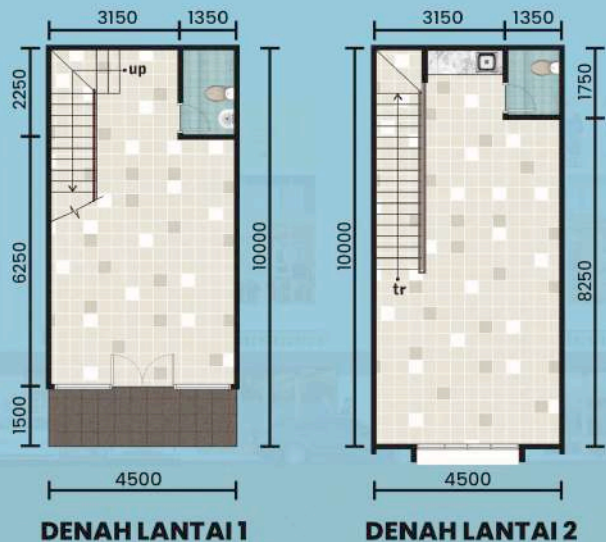

Type **4,5x14 | 16** LT : **63/72 m<sup>2</sup>** | LB : **109 m<sup>2</sup>**





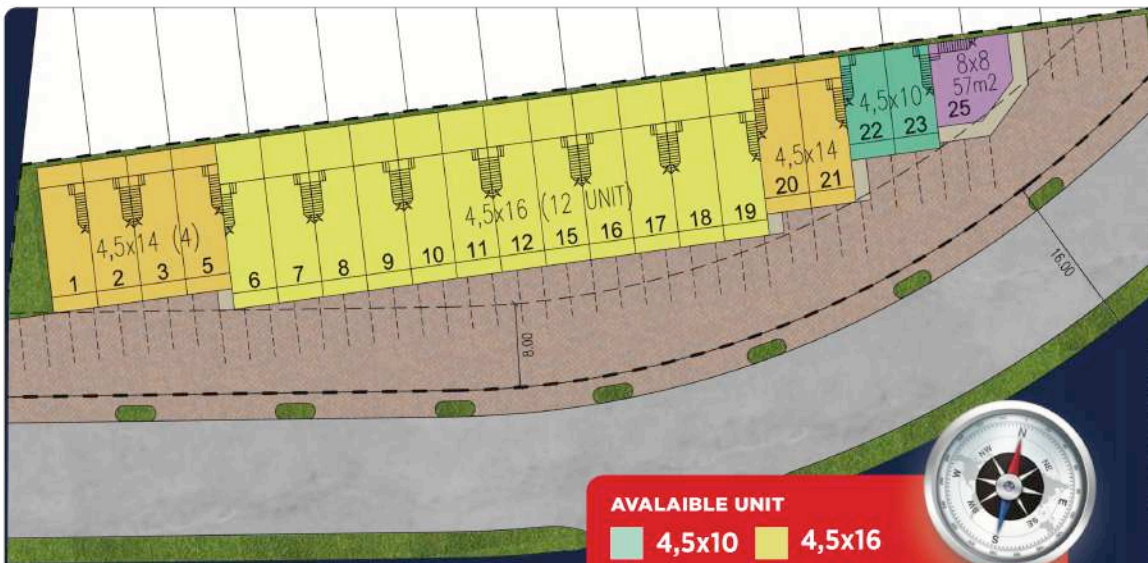

AVAILABLE UNIT

- |   |        |   |            |
|---|--------|---|------------|
|  | 4,5x10 |  | 4,5x16     |
|  | 4,5x14 |  | 8x8 (Hoek) |

**SPESIFIKASI TEKNIS**

Pondasi Strauss pile • Struktur Kolom, Balok, Dak, Sloof, Ring Balok, Tangga Beton Bertulang • Rangka atap Rangka Baja Ringan (Zincalium) • Penutup Atap Atap metal (Zincalium) + aluminium foil • Lantai Utama Homogenous Tile 60x60 • Lantai Teras Keramik 40x40 • Lantai KM/WC Keramik 30x30 • Dinding Dalam Bata Ringan diplester + aci • Dinding Luar Bata Ringan diplester finish Cat Weather Resistant Acrylic Emulsion Paint • Dinding KM/WC Keramik 30x60 • Plafond Dalam Gypsumboard • Plafond Luar Gypsum Waterproof • Sanitary ex. Amstad • Pintu/Jendela Utama Kaca Clear Frame Aluminium fin Powder Coating • Pintu/Jendela Lainnya Kaca Clear Frame Aluminium fin Powder Coating • Pintu KM/WC Panel dan kusen PVC  
**INSTALASI :** Listrik Suplai PLN Daya 3500 VA • Telepon Instalasi Kabel • Air Bersih Suplai PDAM + Toren • Air Kotor Septictank



MERDEKA  
**SALEBRATION**  
2021

# Bavaria

## GRANDE



**PARAMOUNT LAND**  
Building homes and people with heart



Type **4,5x10** LT: **45 m<sup>2</sup>** | LB: **90 m<sup>2</sup>**

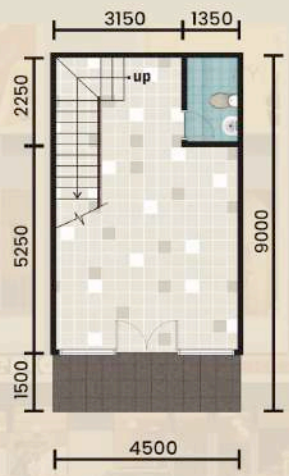

**DENAH LANTAI 1**

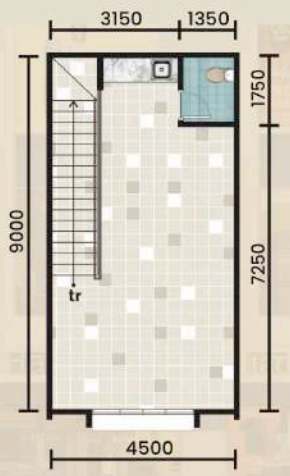

**DENAH LANTAI 2**

Type **4,5x17** LT: **76,5 m<sup>2</sup>** | LB: **121,5 m<sup>2</sup>**

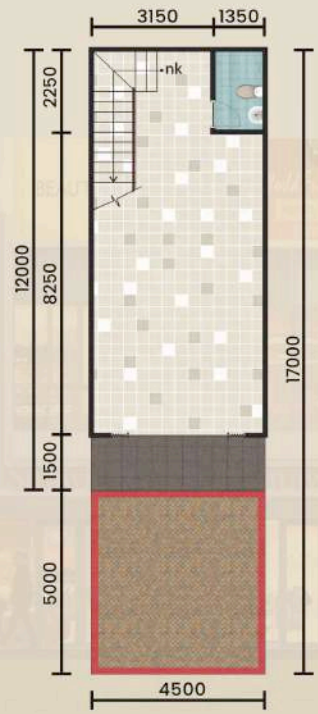

**DENAH LANTAI 1**

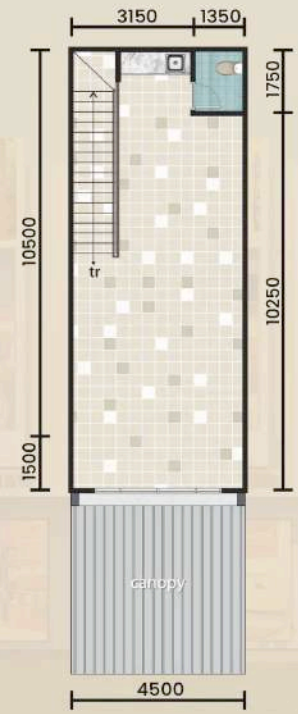

**DENAH LANTAI 2**

Type **4,5x15** | 21 LT : **67,5/94,5 m<sup>2</sup>** | LB : **91 m<sup>2</sup>**



**DENAH LANTAI 1**

**DENAH LANTAI 2**

Type **4,5x15** LT : **93 m<sup>2</sup>** | LB : **113 m<sup>2</sup>**



**DENAH LANTAI 1**

**DENAH LANTAI 2**





Type **5,5x10** (Hoek) LT : 67,5 m<sup>2</sup> | LB : 135 m<sup>2</sup>

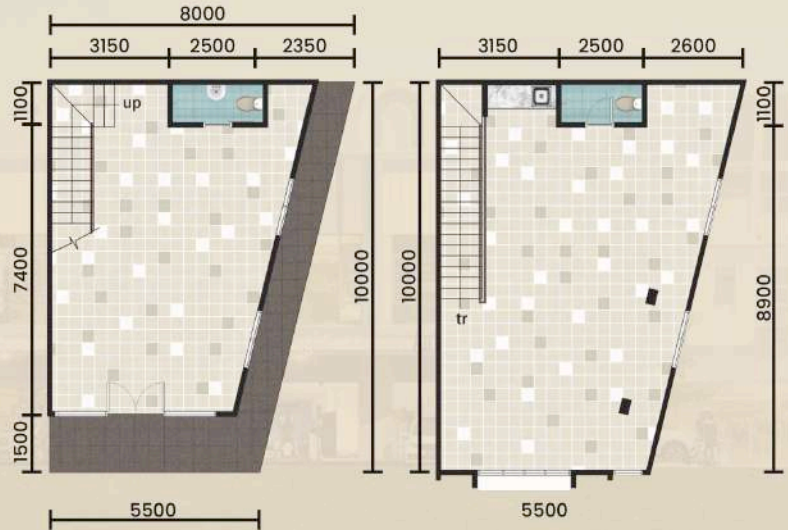

**DENAH LANTAI 1**

**DENAH LANTAI 2**

Type **5,5x17** (Hoek) LT : 93,5 m<sup>2</sup> | LB : 148,5 m<sup>2</sup>



**DENAH LANTAI 1**

**DENAH LANTAI 2**

### Available Unit

- 4,5x10
- 4,5x15 (STD/Hoek)
- 4,5x17 (STD/Hoek)
- 4,5x21
- 5,5x10 (Hoek)
- 5,5x17 (Hoek)



### SPESIFIKASI TEKNIS

**Pondasi** Strauss pile • **Struktur Kolom, Balok, Dak, Sloof, Ring Balok, Tangga** Beton Bertulang • **Rangka atap** Rangka Baja Ringan (Zincalium) • **Penutup Atap** Atap metal (Zincalium) + aluminium foil • **Lantai Utama** Homogenous Tile 60x60 • **Lantai Teras** Keramik 40x40 • **Lantai KM/WC** Keramik 30x30 • **Dinding Dalam** Bata Ringan diplester + aci • **Dinding Luar** Bata Ringan diplester finish Cat Weather Resistant Acrylic Emulsion Paint • **Dinding KM/WC** Keramik 30x60 • **Plafond Dalam** Gypsumboard • **Plafond Luar** Gypsum Waterproof • **Sanitary** ex. Amstad • **Pintu/Jendela Utama** Kaca Clear Frame Aluminium fin Powder Coating • **Pintu/Jendela Lainnya** Kaca Clear Frame Aluminium fin Powder Coating • **Pintu KM/WC** Panel dan kusen PVC • **Canopy Teras Depan** Atap metal (Zincalium) + Rangka Besi hollow **INSTALASI** : **Listrik** Suplai PLN Daya 3500 VA • **Telepon** Instalasi Kabel • **Air Bersih** Suplai PDAM + Toren • **Air Kotor** Septictank

### POTONGAN RUKO





**MERDEKA**  
**SALEBRATION**  
**2021**



Akses Tol  
Jakarta-Tangerang



BPK Penabur

Stella Mars

Clinic  
Mom's & Child

Matana University

Tarakanita

Universitas  
Multimedia Nusantara

Superindo

Giant Hypermarket

SMS

Hypermart



St. Carolus

Pracita University



Bethsaida Clinic

