



Bintaro Jaya
the professional's city

The logo for U-VILLE AVENUE, featuring a stylized white and black roof icon above the text "U-VILLE" in a large, white, sans-serif font, with "AVENUE" in a smaller, white, sans-serif font underneath.

U-VILLE
AVENUE

The logo for ALFRESCA, featuring the word "ALFRESCA" in a large, bold, pink, sans-serif font.

ALFRESCA



ALFRESCA SUDUT  84m²  193m²



Lantai 1

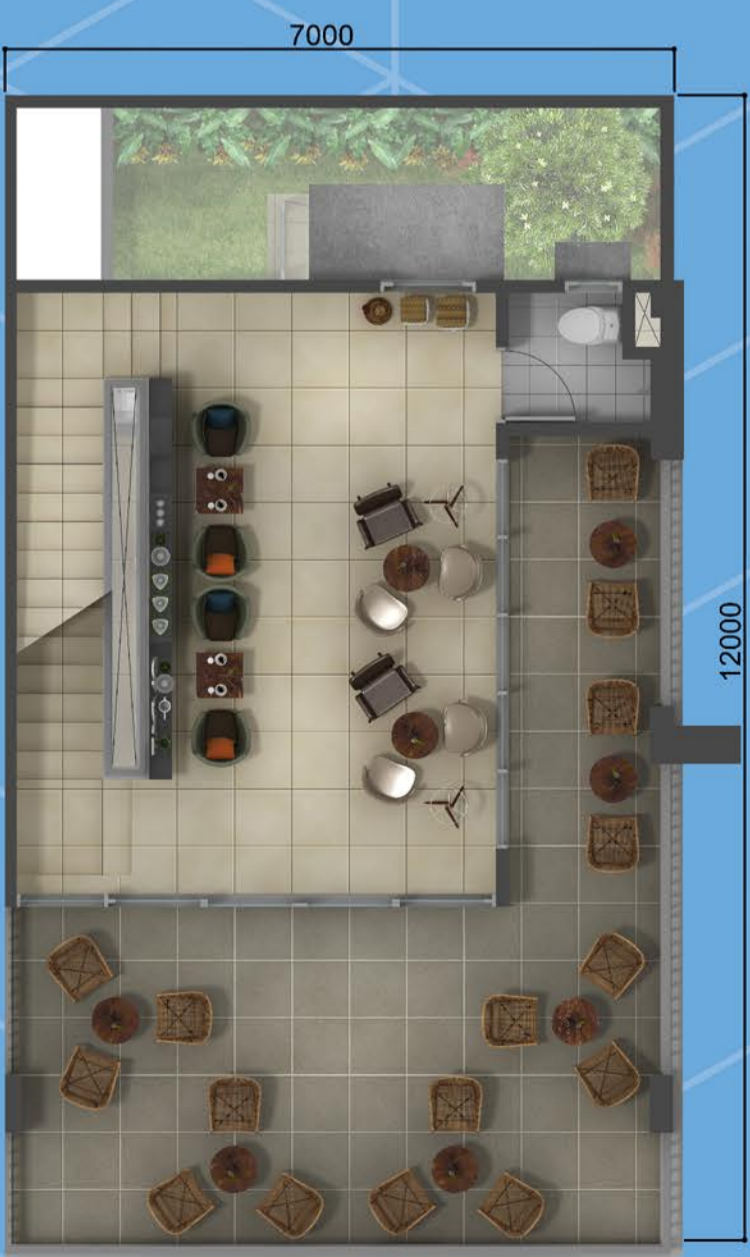

Lantai 2

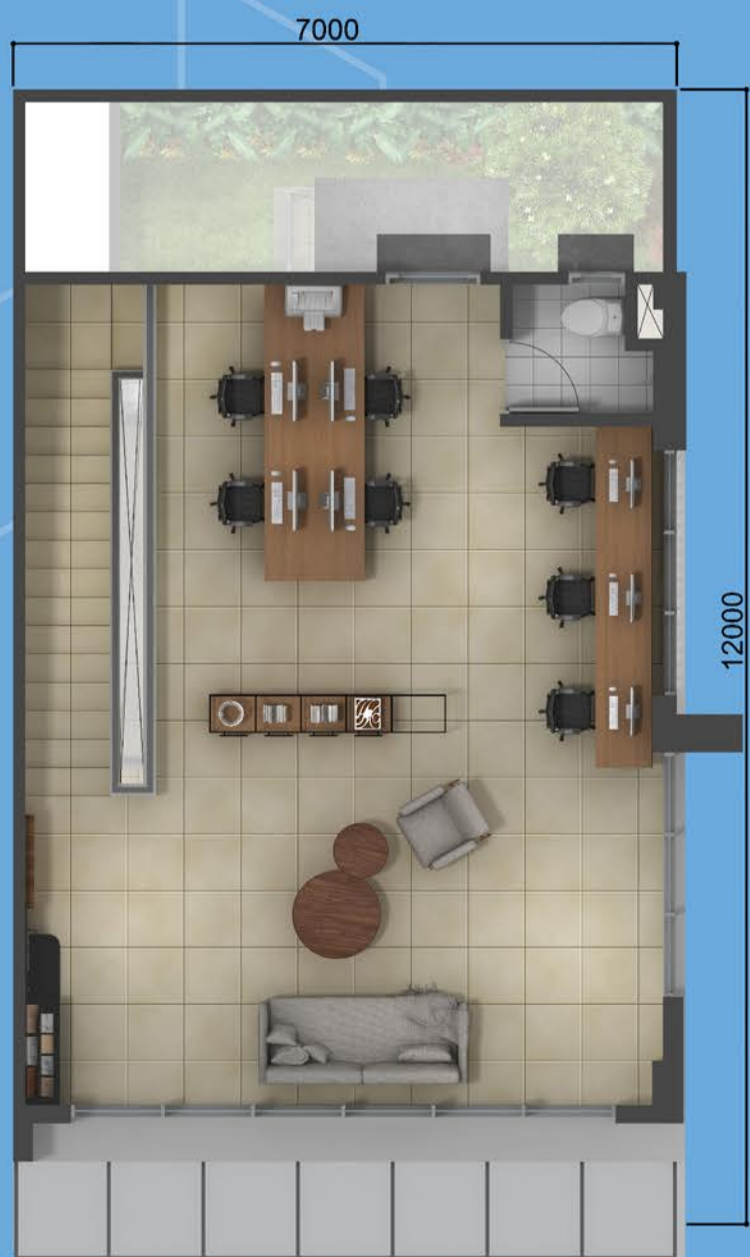

Lantai 3



ALFRESCA STANDAR

 72m²  172m²



Lantai 1



Lantai 2



Lantai 3

SPESIFIKASI

FINISHING

Lantai Dalam	: Homogenous Tile
Kamar Mandi	: Keramik
Koridor	: Keramik
Dinding Luar	: Finishing Cat (weathershield) + ACP
Dinding Dalam	: Finishing Cat
Kusen Jendela & Pintu	: Aluminium + Kayu Fabrikasi
Pintu Depan	: Aluminium Kaca
Pintu Toilet	: Pintu Fabrikasi
Penutup Atap	: Atap Metal

STRUKTUR

Pondasi	: Tiang Pancang
Struktur Atas	: Dinding Bata Ringan, Beton Bertulang
Rangka Atap	: Baja Ringan

INSTALASI

Air Bersih	: PAM Bintaro Jaya
Listrik	: 3500 VA



LOKASI

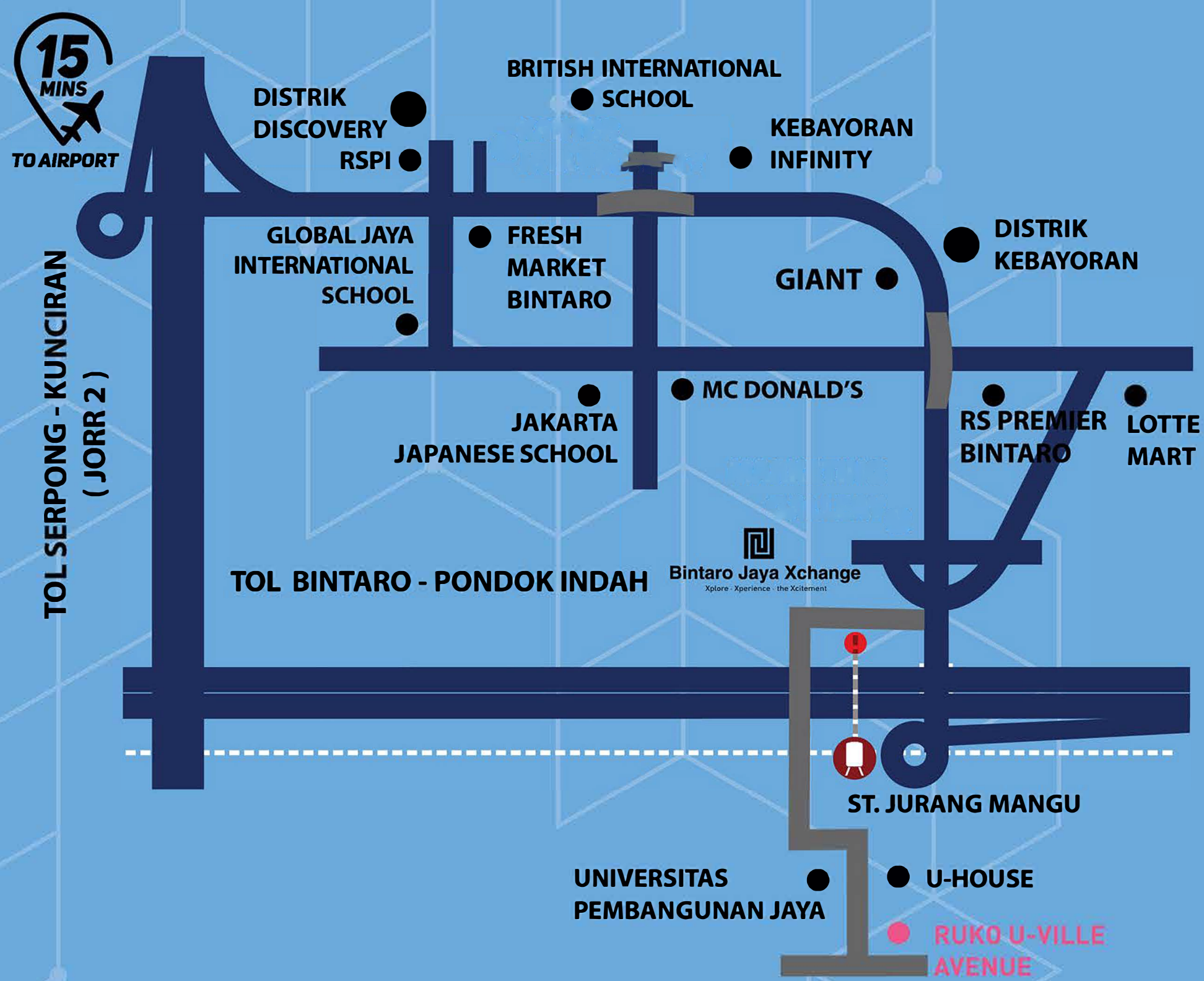

FASILITAS



STASIUN JURANGMANGU



TOL PONDOK AREN



INTRANS BINTARO



RUMAH SAKIT PONDOK INDAH BINTARO



BINTARO XCHANGEMALL



UNIVERSITAS PEMBANGUNAN JAYA

Marketing

KAMI REALTY KAMI PROPRTI

Boulevard Bintaro Jaya Blok B7/D2 No. 1
Bintaro Jaya Sektor 7

☎ 0819 9000 1919



KAMI REALTY



@kamirealtyofficial

www.kamirealty.co.id